

# Installation Instructions

Series 551

**PHOTONIC.**  
LIGHTING SOLUTIONS

1. Remove grub screws from baseplate.

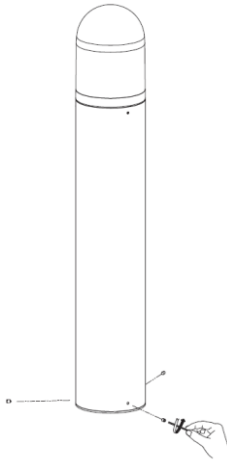

2. Secure baseplate onto surface using appropriate bolts

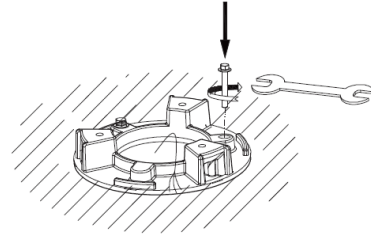

3. Make mains connection in suitable IP connection (not supplied)

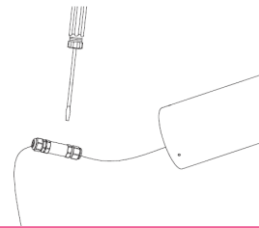

4. Tuck cable inside Bollard

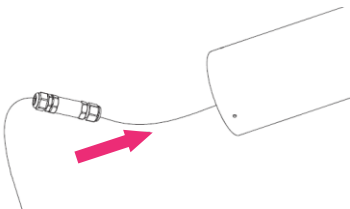

5. Place onto Baseplate and secure with grub screws.

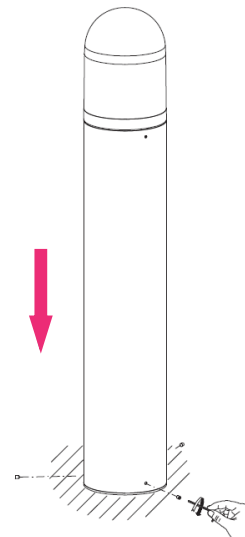

6. Power on.

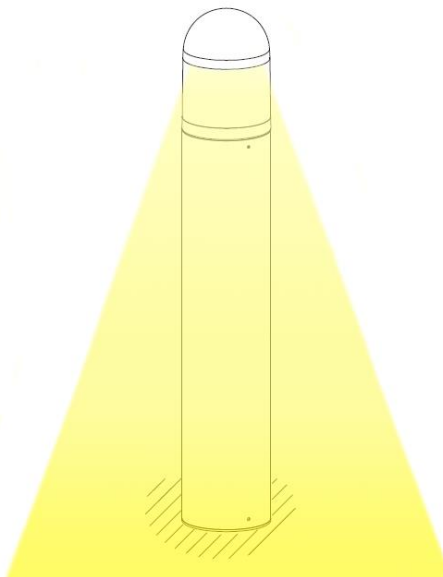

01282 476600 | [info@photoniclighting.co.uk](mailto:info@photoniclighting.co.uk)

Unit 1 Boran Court, Network 65, Hapton, Burnley BB11 5TH

[www.photoniclighting.co.uk](http://www.photoniclighting.co.uk)