

Installation Instructions

Series 502

PHOTONIC.
LIGHTING SOLUTIONS

1. Remove Product from all packaging

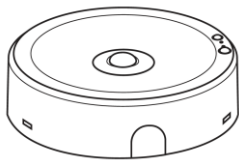

2. Unclip base plate from main housing.

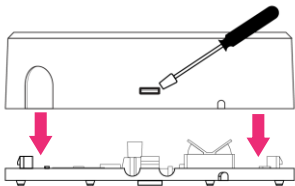

3. Screw to base plate to ceiling using fixing holes.

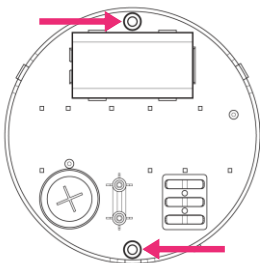

4. Feed in Cable and wire Mains as per Electrical Standards

Self test version

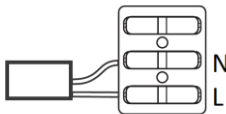

DALI version

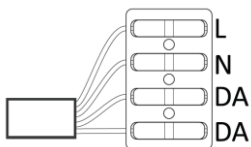

5. Line up clips and clip housing into place.

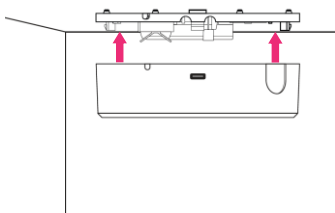

6. Power on and test.



7. Commission & log commissioning details



Part No.	
X 1	180
Commissioning Date: __/__/__	

Part No.	
Date Of Manufacture MM/YYYY	
Commissioning Date: __/__/__	

